

Technical Specification

VP Screwed

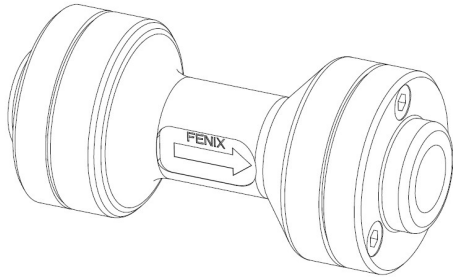

General Description

The VP (Variable Process) is designed for process applications(*) and can be supplied with screwed connections.

The body of the trap fits between the inlet and outlet connector to allow access to the nozzle without having to remove the complete assembly from the pipework.

Connections

Thread NPT / BSP

Operating Parameters (ISO 6552:1980)

PMA	1450 psig (100 barg)
TMA	1022°F (550 °C)
PMO	435 psig (30 barg) @ 500 °F (260°C)
TMO	572°F (300 °C) @ 0 psig (0 barg)

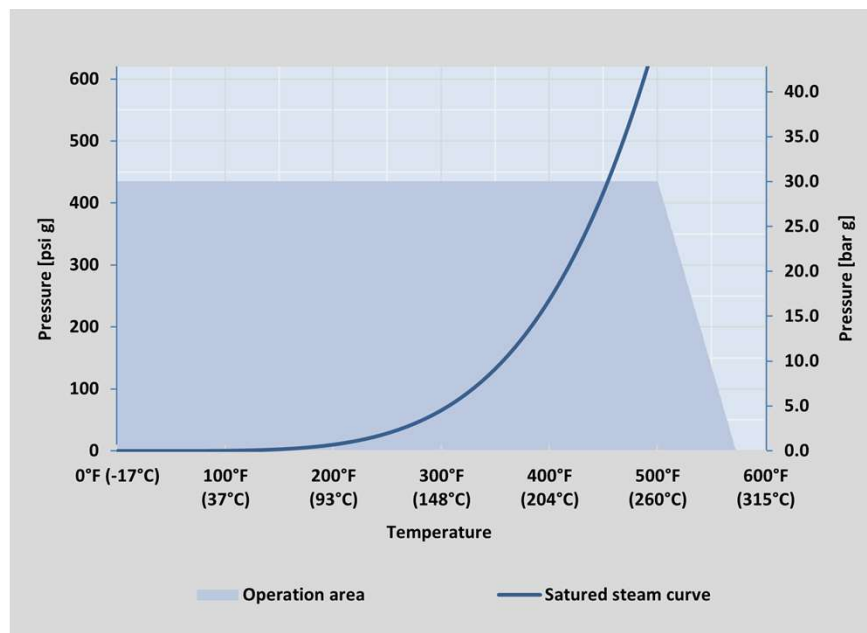

(*) process applications include shell and tube heat exchangers, air heaters, calorifiers, cooking vessels, etc. The traps will operate over the full range of the process from minimum load to the maximum load.

Construction

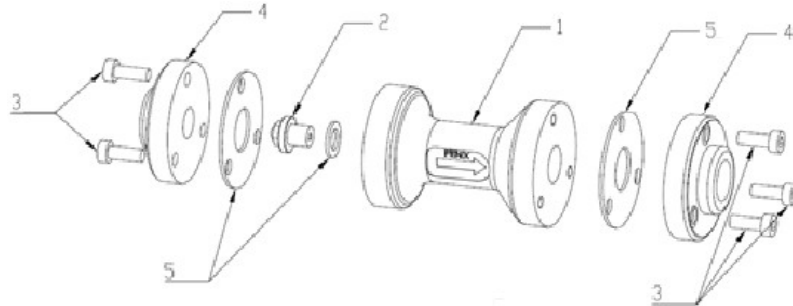

No.	Part	Material
1	Trap body	304L stainless steel
2	Inlet removable nozzle	316 stainless steel
3	Bolts	Carbon steel
4	Connector Flange	304L stainless steel
5	Gaskets	Graphite reinforced with stainless steel

Dimensions

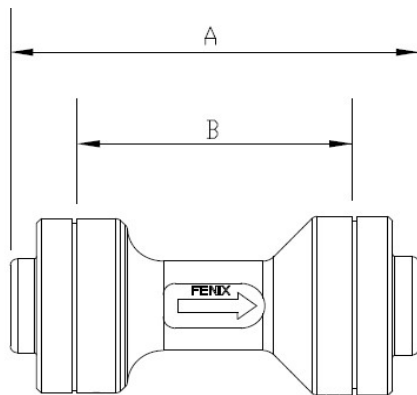

Spare parts

Part	Code
Connection Gasket	G-9 for VP 1 ½" G-10 for VP 2"
Nozzle Gasket	G-4 for VP 1 ½" G-5 for VP 2"

Size	A	B	Weight (approx.)
1 ½" (DN40)	8.58" (218 mm)	6.3" (160 mm)	8.4 lb (3.8 kg)
2" (DN50)	9.44" (240 mm)	7.08" (180 mm)	9.2 lb (4.2 kg)